



50Hz

# Comfort Home Water Solutions

The Comfort Home Beluga • IDS series all stainless steel submersible drainage & sump pumps are designed for sump, drainage, and grey water & pure water transferring applications. These pumps are equipped with a semi-open stainless steel impeller capable of passing 8mm solids. The combination of stainless steel shaft and oil filled lip seal with silicon carbide mechanical seal result in an extremely long operating life and make these pumps suitable for use by home owner or even contractors.

## BELUGA

### IDS Series

All Stainless Steel Submersible Drainage & Sump Pump

Residential, Light Commercial & Irrigation



#### Features

- Stainless steel motor housing and pump casing for tougher application
- All models are hermetically sealed to be watertight, dust-tight, and completely submersible
- Triple seal (mechanical seal + 2 oil seals) and oil seal chamber design to improve bearing lubrication and prevent leaking problem
- High efficiency dry type motor for environmental friendly
- Robust construction for better reliability
- Auto reset thermal overload protection for longer motor life
- Portable design for easy transporting

Power	Max.Flow	Max.Head
550 - 1500 W	Up to 420 L/min	Up to 20.6 M

#### Application

- Basement water removal
- Waste water drainage
- Water transfer
- Sump/effluent handling
- Dewatering
- Fish pond & fountain circulation
- Factory waste water handling

#### Performance Curves

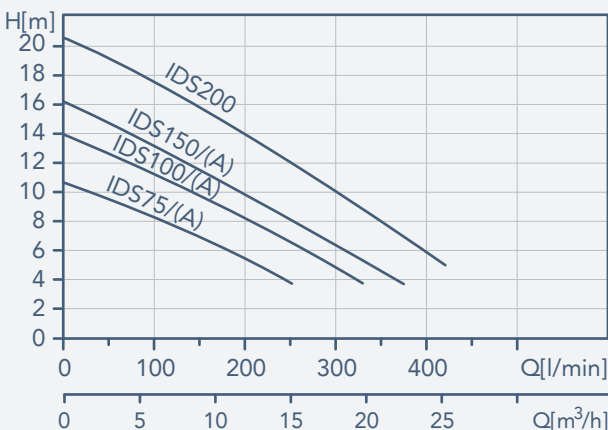

#### General Data

Motor Spec	
Motor Type	2 POLE, dry type
Frequency	50HZ
Standard Voltages	1Ø 220 - 240 V
	3Ø 380 - 415 V
Insulation Class	F class (155°C)
Enclosure Protection Class	IP 68
Nominal Speed	2850 rpm
Operation Conditions	
Liquid Temperature	2°C - 40°C
Lowest Depth	Max. 7M

## Materials

Pos.	Description	Material
1	Cable	H07RN-F
2	Handle	SUS 304+Noryl
3	Pump Cover	SUS 304
4	Motor Cover	SUS 304
5	Housing	SUS 304
6	Fixing Ring	Noryl+30GF
7	Pump Body	SUS 304
8	Mechanical Seal	Carbon+Silicon Carbide+NBR
9	Impeller	SUS 304
10	Key	SUS 304
11	O-Ring	NBR
12	Oil Seal	NBR
13	Shaft	SUS 304
14	V-type Axial Oil Seal	NBR
15	Suction	SUS 304+Thermoplastic polyurethane TPU
16	Strainer	SUS 304
17	Pump Casing	SUS 304

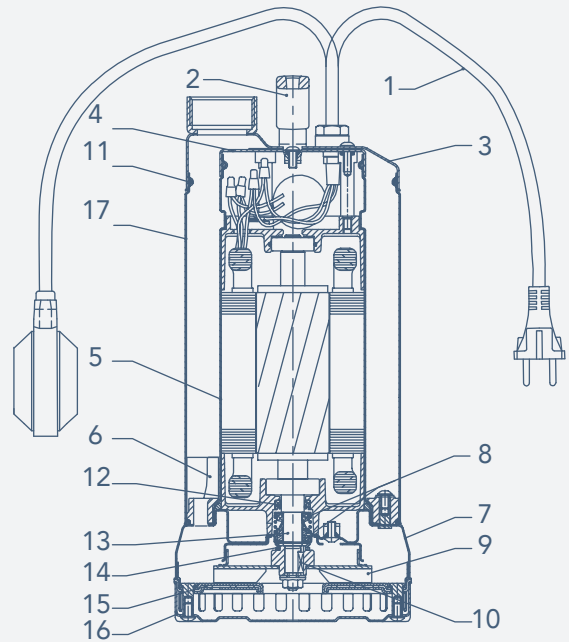

## Dimensions (mm)

Model	Phase Ø	Dimensions				
		H	H1	H2	L	L1
IDS75(A)	1	357	437	341	459	370
IDS75	3	357	-	341	-	-
IDS100(A)	1	407	497	391	514	425
IDS100	3	357	-	341	-	-
IDS150(A)	1	407	497	391	514	425
IDS150	3	407	-	391	-	-
IDS200	3	407	-	391	-	-

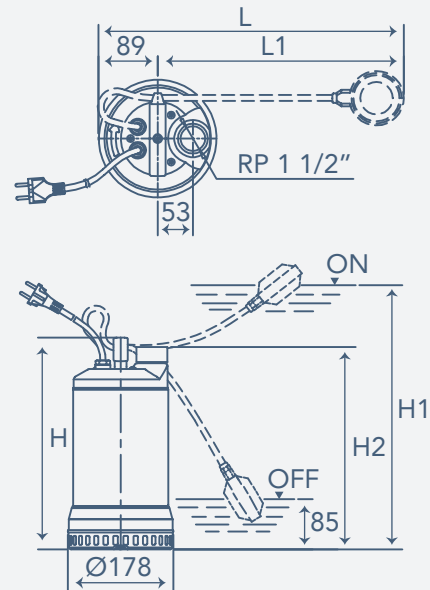

## Specifications

Model	Phase Ø	Voltage (V)	Power		Head (Pressure)		Flow (Capacity)		Pipe Connection		Pass Solid (Dia) mm	Cord Length M	Dimension L x W x H (mm)	Weight (kg)
			HP	W	Rated (M)	Max. (M)	Rated (L/Min)	Max. (L/Min)	mm	Inch				
IDS75(A)	1	220-240	0.75	550	8.6	10.9	100	250	40	1-1/2	8	10	178 x 178 x 357	11/(11.5)
IDS75	3	380-415	0.75	550	8.6	10.9	100	250	40	1-1/2	8	10	178 x 178 x 357	11
IDS100(A)	1	220-240	1	750	11.2	14	100	325	40	1-1/2	8	10	178 x 178 x 407	14/(14.5)
IDS100	3	380-415	1	750	11.2	14	100	325	40	1-1/2	8	10	178 x 178 x 357	11
IDS150(A)	1	220-240	1.5	1100	11.9	16.1	150	375	40	1-1/2	8	10	178 x 178 x 407	16/(16.5)
IDS150	3	380-415	1.5	1100	11.9	16.1	150	375	40	1-1/2	8	10	178 x 178 x 407	14
IDS200	3	380-415	2	1500	15.6	20.6	150	420	40	1-1/2	8	10	178 x 178 x 407	16

• Model with "A" is automatic version.